



DO NOT SCALE

© Crown copyright and database rights 2012.
Ordnance Survey 100021668



Notes

LEGEND

-  EXISTING ROAD MARKINGS
-  PROPOSED WHITE ROAD MARKINGS
-  EXTENTS (TLRN, WCC)

NOTES

- Advisory cycle lanes proposed at 1.5m minimum width.
- Drawings have been produced on OS map data, therefore dimensions are subject to on site review.
- Vehicle lane widths vary across the sections of carriageway.

Rev	Description	By	Date	Chk
01	RSA 1 RESPONSE	TS	MAY 23	PW

DEPARTMENT OF TRANSPORTATION AND HIGHWAYS
Traffic & Transportation Policy Service



THE ROYAL BOROUGH OF KENSINGTON AND CHELSEA
The Royal Borough of Kensington and Chelsea
Town Hall, Hornton Street, London, W8 7NX
Telephone: (020) 7361 3374
Fax: (020) 7361 2796

Project
PROPOSED KENSINGTON HIGH STREET LIGHT SEGREGATION

Title
FOR INFORMATION (WEST OF ECR)

Scale 1:200	Drawn Date	TS MAR 2023	Checked Date	PW MAR 2023	A1
----------------	---------------	----------------	-----------------	----------------	-----------

Drawing Number 000-1200-01	Rev 01
-------------------------------	-----------

For Information

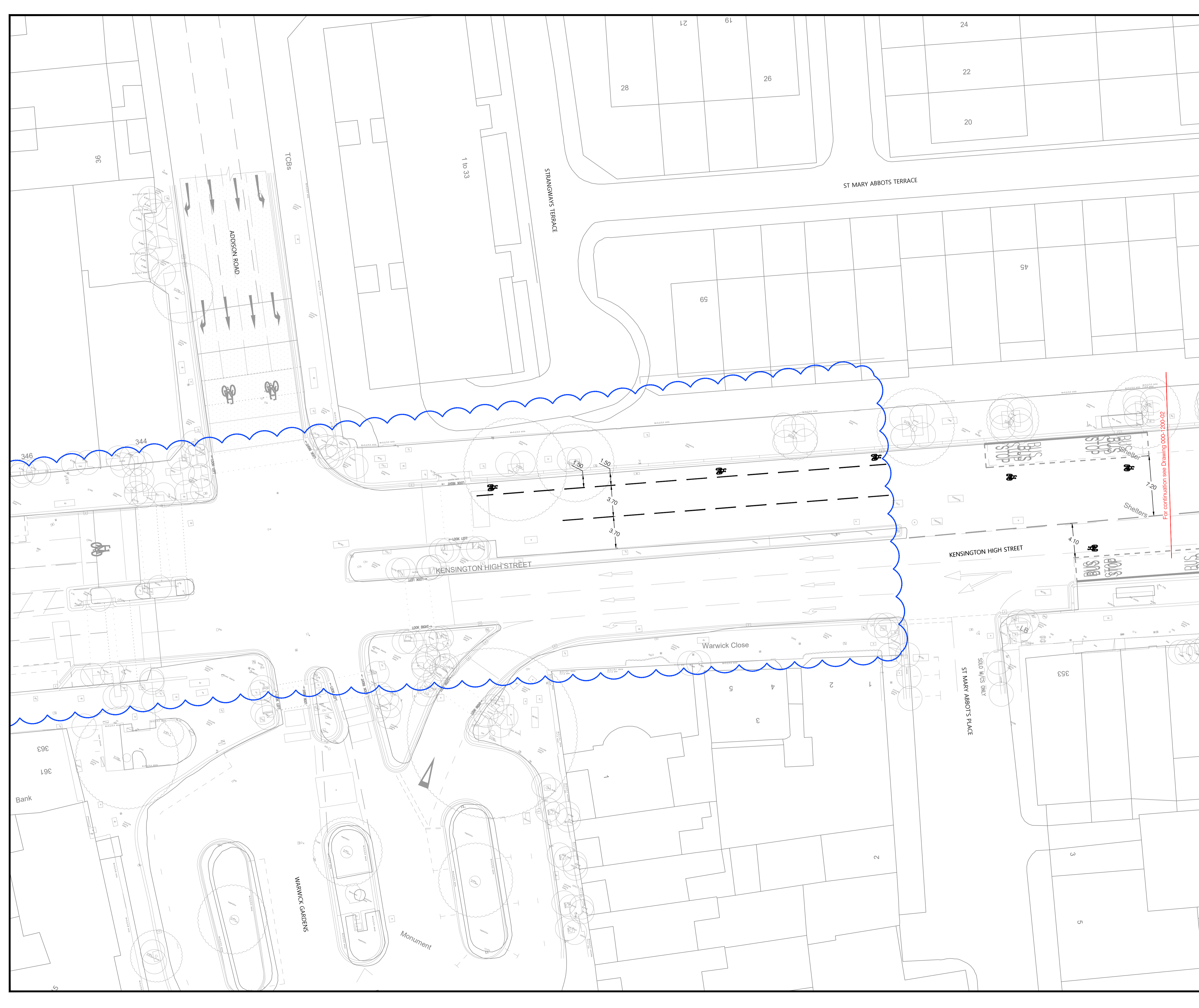

DO NOT SCALE

© Crown copyright and database rights 2012.
Ordnance Survey 100021668



Notes

LEGEND

- EXISTING ROAD MARKINGS
- PROPOSED WHITE ROAD MARKINGS
- EXTENTS (TLRN, WCC)

NOTES

- Advisory cycle lanes proposed at 1.5m minimum width.
- Drawings have been produced on OS map data, therefore dimensions are subject to on site review.
- Vehicle lane widths vary across the sections of carriageway.

Rev	Description	By	Date	Chk
01	RSA 1 RESPONSE	TS	MAY 23	PW

DEPARTMENT OF TRANSPORTATION AND HIGHWAYS
Traffic & Transportation Policy Service



The Royal Borough of Kensington and Chelsea
Town Hall, Hornton Street, London, W8 7NX
Telephone: (020) 7361 3374
Fax: (020) 7361 2796

Project
PROPOSED KENSINGTON HIGH STREET LIGHT SEGREGATION

Title
FOR INFORMATION (WEST OF ECR)

Scale 1:200	Drawn Date MAR 2023	TS Date MAR 2023	Checked Date MAR 2023	PW	A1
----------------	------------------------	---------------------	--------------------------	----	-----------

Drawing Number 000-1200-02	Rev 01
-------------------------------	-----------

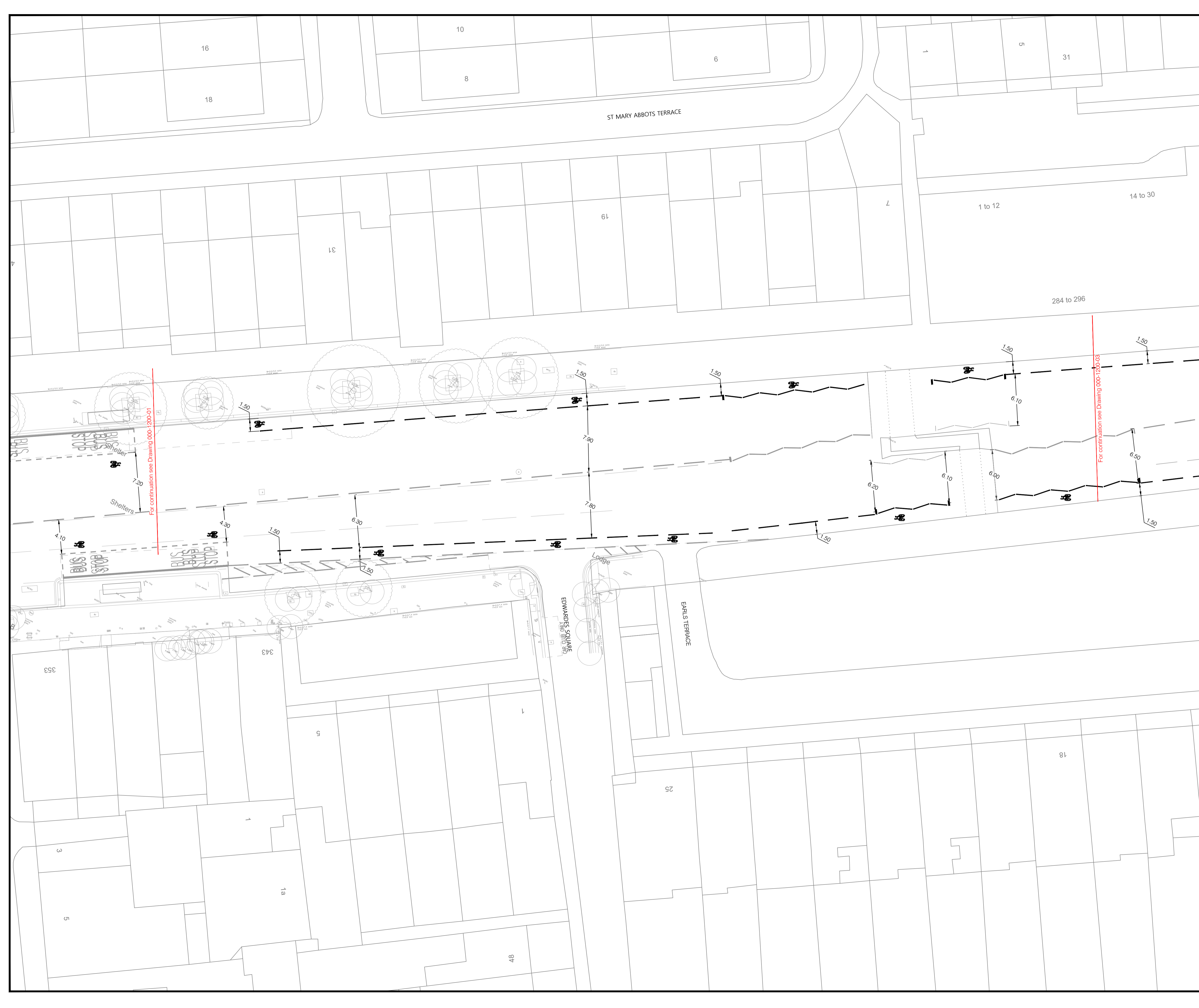

Cad File : \DRAWINGS\...

DO NOT SCALE

© Crown copyright and database rights 2012.
Ordnance Survey 100021668



Notes

LEGEND

- EXISTING ROAD MARKINGS
- PROPOSED WHITE ROAD MARKINGS
- EXTENTS (TLRN, WCC)

NOTES

- Advisory cycle lanes proposed at 1.5m minimum width.
- Drawings have been produced on OS map data, therefore dimensions are subject to on site review.
- Vehicle lane widths vary across the sections of carriageway.

01	RSA 1 RESPONSE	TS	MAY 23	PW
Rev	Description	By	Date	Chk

DEPARTMENT OF TRANSPORTATION AND HIGHWAYS
Traffic & Transportation Policy Service

The Royal Borough of Kensington and Chelsea
Town Hall, Hornton Street, London, W8 7NX
Telephone: (020) 7361 3374
Fax: (020) 7361 2796

Project
PROPOSED KENSINGTON HIGH STREET LIGHT SEGREGATION

Title
FOR INFORMATION (WEST OF ECR)

Scale	1:200	Drawn	TS	Checked	PW	A1
Drawing Number	000-1200-03	Date	MAR 2023	Date	MAR 2023	
						Rev 01



Call File: *DRAWINGS...

DO NOT SCALE

© Crown copyright and database rights 2012.
Ordnance Survey 100021668



Notes

LEGEND

- EXISTING ROAD MARKINGS
- PROPOSED WHITE ROAD MARKINGS
- EXTENTS (TLRN, WCC)

NOTES

- Advisory cycle lanes proposed at 1.5m minimum width.
- Drawings have been produced on OS map data, therefore dimensions are subject to on site review.
- Vehicle lane widths vary across the sections of carriageway.

Rev	Description	By	Date	Chk
01	RSA 1 RESPONSE	TS	MAY 23	PW

DEPARTMENT OF TRANSPORTATION AND HIGHWAYS
Traffic & Transportation Policy Service

The Royal Borough of Kensington and Chelsea
Town Hall, Homton Street, London, W8 7NX
Telephone: (020) 7361 3374
Fax: (020) 7361 2796

Project
PROPOSED KENSINGTON HIGH STREET LIGHT SEGREGATION

Title
FOR INFORMATION (WEST OF ECR)

Scale 1:200	Drawn Date TS MAR 2023	Checked Date PW MAR 2023	A1
Drawing Number 000-1200-04			Rev 01



Cad File : \DRAWINGS\...

DO NOT SCALE

© Crown copyright and database rights 2012.
Ordnance Survey 100021668



Notes

LEGEND

- EXISTING ROAD MARKINGS
- PROPOSED WHITE ROAD MARKINGS
- EXTENTS (TLRN, WCC)

NOTES

- Advisory cycle lanes proposed at 1.5m minimum width.
- Drawings have been produced on OS map data, therefore dimensions are subject to on site review.
- Vehicle lane widths vary across the sections of carriageway.

01	RSA 1 RESPONSE	TS	MAY 23	PW
Rev	Description	By	Date	Chk

DEPARTMENT OF TRANSPORTATION AND HIGHWAYS
Traffic & Transportation Policy Service



THE ROYAL BOROUGH OF KENSINGTON AND CHELSEA

The Royal Borough of Kensington and Chelsea
Town Hall, Hornton Street, London, W8 7NX
Telephone: (020) 7361 3374
Fax: (020) 7361 2796

Project
PROPOSED KENSINGTON HIGH STREET LIGHT SEGREGATION

Title
FOR INFORMATION (EAST OF KEN CH ST)

Scale 1:200	Drawn Date MAR 2023	TS Date MAR 2023	Checked Date MAR 2023	PW	A1
Drawing Number 001-1200-01				Rev 01	



Cad File : \DRAWINGS\...

DO NOT SCALE

© Crown copyright and database rights 2012.
Ordnance Survey 100021668



Notes

LEGEND

- EXISTING ROAD MARKINGS
- PROPOSED WHITE ROAD MARKINGS
- EXTENTS (TLRN, WCC)

NOTES

- Advisory cycle lanes proposed at 1.5m minimum width.
- Drawings have been produced on OS map data, therefore dimensions are subject to on site review.
- Vehicle lane widths vary across the sections of carriageway.

Rev	Description	By	Date	Chk
01	RSA 1 RESPONSE	TS	MAY 23	PW

DEPARTMENT OF TRANSPORTATION AND HIGHWAYS
Traffic & Transportation Policy Service



THE ROYAL BOROUGH OF KENSINGTON AND CHELSEA

The Royal Borough of Kensington and Chelsea
Town Hall, Hornton Street, London, W8 7NX
Telephone: (020) 7361 3374
Fax: (020) 7361 2796

Project
PROPOSED KENSINGTON HIGH STREET LIGHT SEGREGATION

Title
FOR INFORMATION (EAST OF KEN CH ST)

Scale 1:200	Drawn Date MAR 2023	TS	Checked Date MAR 2023	PW	A1
Drawing Number 001-1200-02	Rev 01				



Cad File : \DRAWINGS\...



DO NOT SCALE

© Crown copyright and database rights 2012.
Ordnance Survey 100021668



Notes

LEGEND

-  EXISTING ROAD MARKINGS
-  PROPOSED WHITE ROAD MARKINGS
-  EXTENTS (TLRN, WCC)

NOTES

- Advisory cycle lanes proposed at 1.5m minimum width.
- Drawings have been produced on OS map data, therefore dimensions are subject to on site review.
- Vehicle lane widths vary across the sections of carriageway.

Rev	Description	By	Date	Chk
01	RSA 1 RESPONSE	TS	MAY 23	PW

DEPARTMENT OF TRANSPORTATION AND HIGHWAYS
Traffic & Transportation Policy Service



THE ROYAL BOROUGH OF KENSINGTON AND CHELSEA
The Royal Borough of Kensington and Chelsea
Town Hall, Hornton Street, London, W8 7NX
Telephone: (020) 7361 3374
Fax: (020) 7361 2796

Project
PROPOSED KENSINGTON HIGH STREET LIGHT SEGREGATION

Title
FOR INFORMATION (EAST OF KEN CH ST)

Scale 1:200	Drawn Date TS MAR 2023	Checked Date PW MAR 2023	A1
Drawing Number 001-1200-03			Rev 01

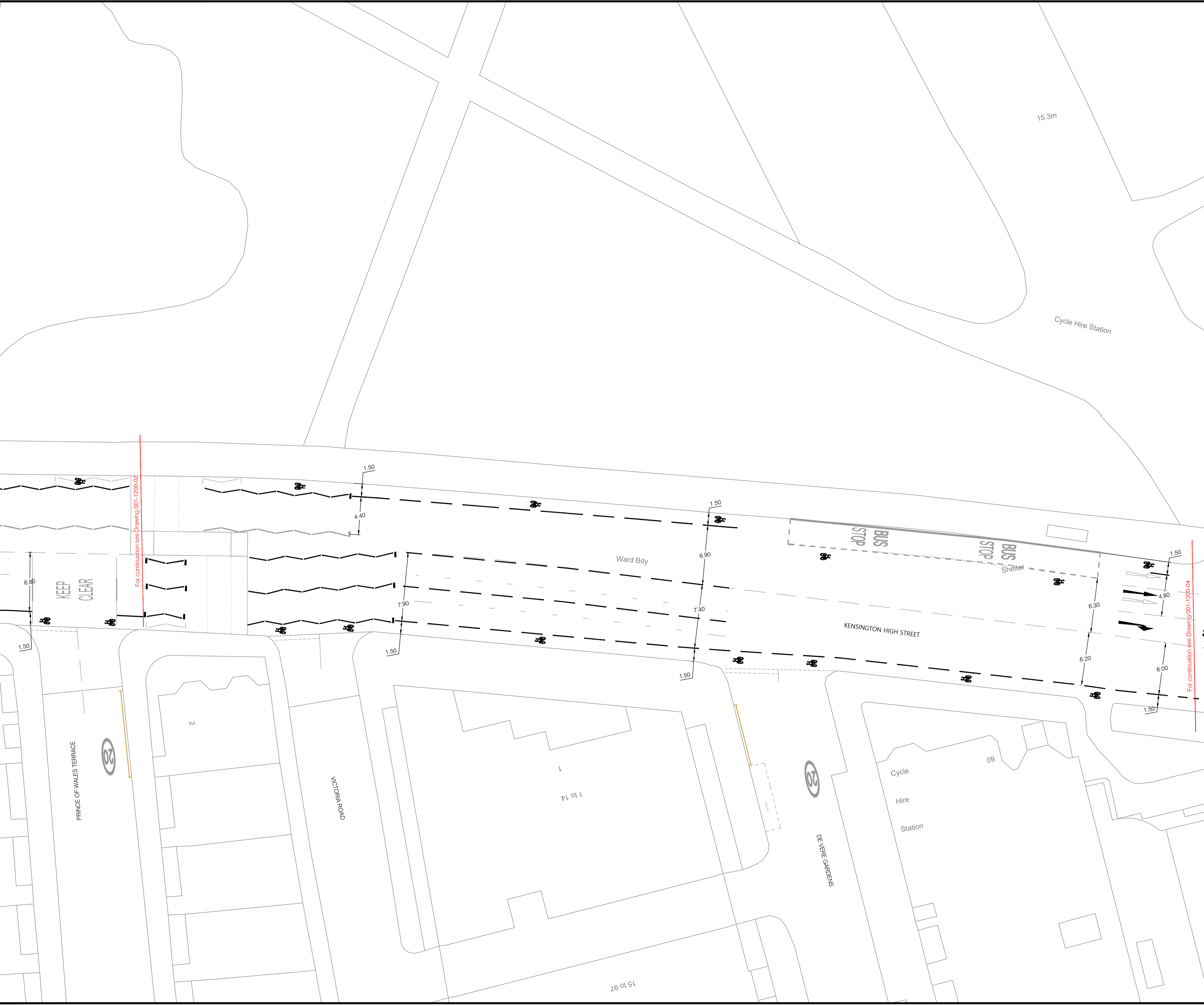

Cad File : \DRAWINGS\...

DO NOT SCALE

© Crown copyright and database rights 2012.
Ordnance Survey 100021668



Notes

LEGEND

- EXISTING ROAD MARKINGS
- PROPOSED WHITE ROAD MARKINGS
- EXTENTS (TLRN, WCC)

NOTES

- Advisory cycle lanes proposed at 1.5m minimum width.
- Drawings have been produced on OS map data, therefore dimensions are subject to on site review.
- Vehicle lane widths vary across the sections of carriageway.

Rev	Description	By	Date	Chk
01	RSA 1 RESPONSE	TS	MAY 23	PW

DEPARTMENT OF TRANSPORTATION AND HIGHWAYS
Traffic & Transportation Policy Service



THE ROYAL BOROUGH OF KENSINGTON AND CHELSEA
The Royal Borough of Kensington and Chelsea
Town Hall, Hornton Street, London, W8 7NX
Telephone: (020) 7361 3374
Fax: (020) 7361 2796

Project
PROPOSED KENSINGTON HIGH STREET LIGHT SEGREGATION

Title
FOR INFORMATION (EAST OF KEN CH ST)

Scale 1:200	Drawn Date MAR 2023	TS Checked Date MAR 2023	PW Date MAR 2023	A1
Drawing Number 001-1200-04				Rev 01

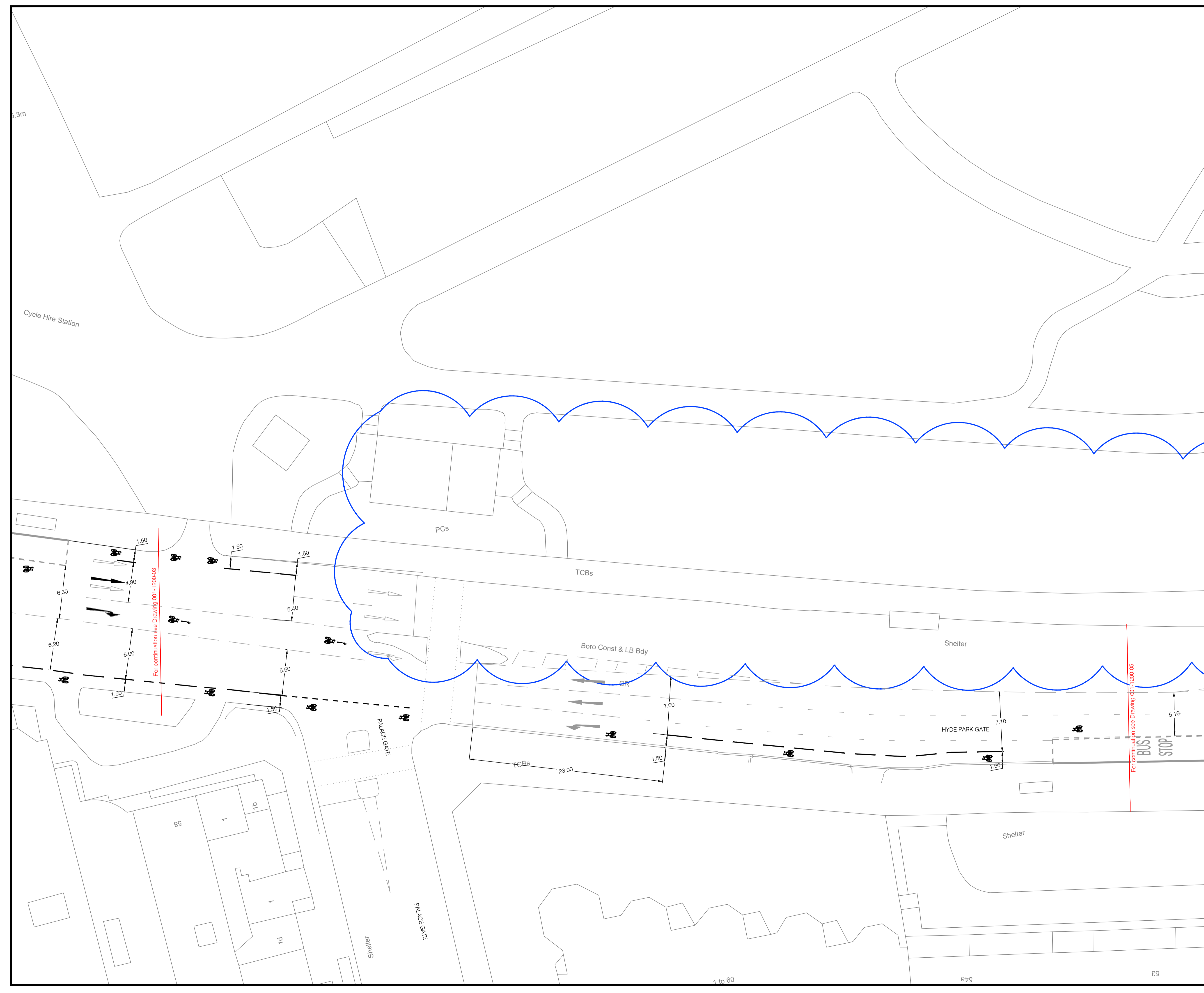

Cad File : \DRAWINGS\...

DO NOT SCALE

© Crown copyright and database rights 2012.
Ordnance Survey 100021668



Notes

LEGEND

- EXISTING ROAD MARKINGS
- PROPOSED WHITE ROAD MARKINGS
- EXTENTS (TLRN, WCC)

NOTES

- Advisory cycle lanes proposed at 1.5m minimum width.
- Drawings have been produced on OS map data, therefore dimensions are subject to on site review.
- Vehicle lane widths vary across the sections of carriageway.

Rev	Description	By	Date	Chk
01	RSA 1 RESPONSE	TS	MAY 23	PW



DEPARTMENT OF TRANSPORTATION AND HIGHWAYS
 Traffic & Transportation Policy Service
 The Royal Borough of Kensington and Chelsea
 Town Hall, Hornton Street, London, W8 7NX
 Telephone: (020) 7361 3374
 Fax: (020) 7361 2796

Project
PROPOSED KENSINGTON HIGH STREET LIGHT SEGREGATION

Title
FOR INFORMATION (EAST OF KEN CH ST)

Scale 1:200	Drawn Date TS MAR 2023	Checked Date PW MAR 2023	A1
Drawing Number 001-1200-05			Rev 01

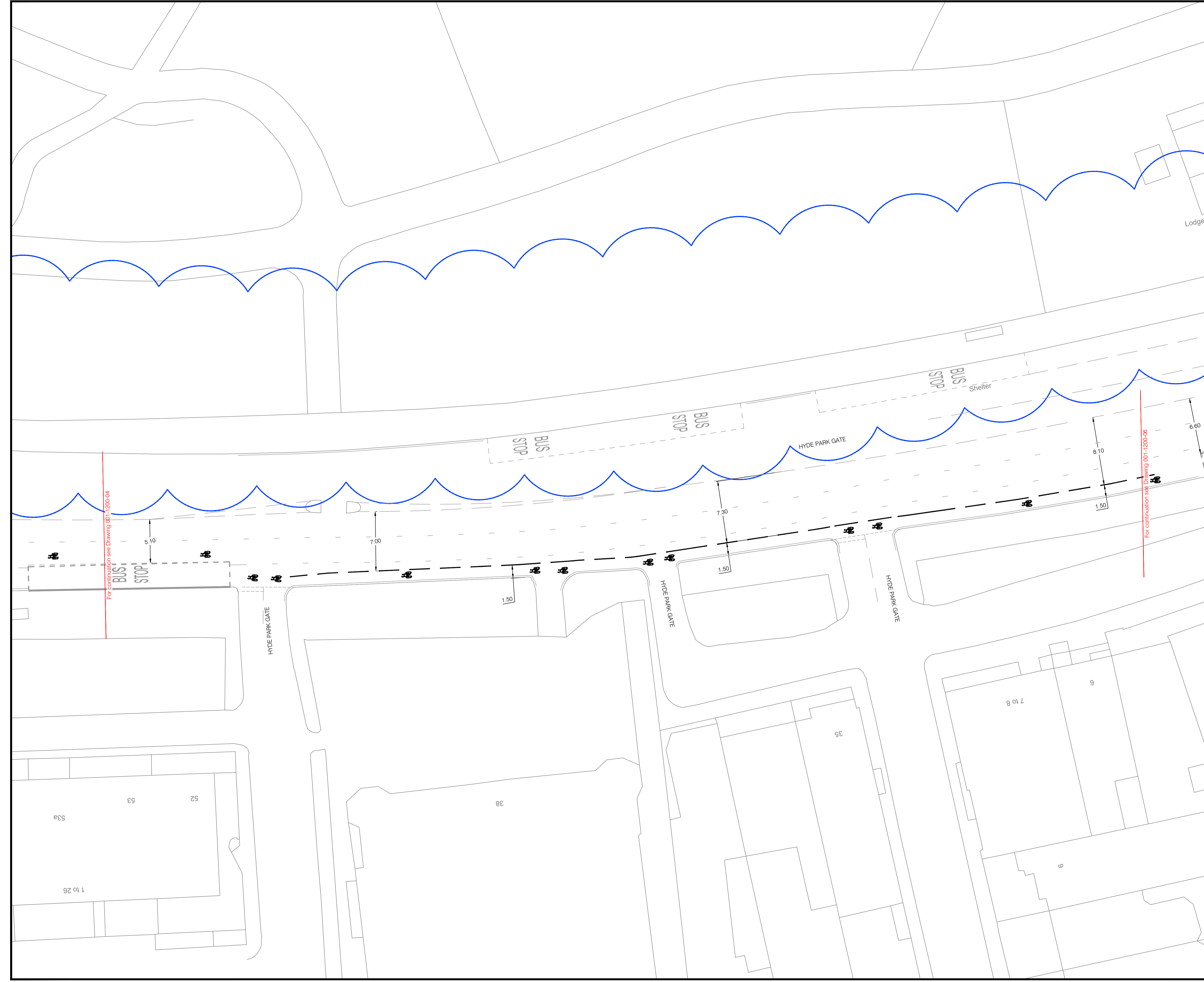
Cad File : \DRAWINGS\...



DO NOT SCALE

© Crown copyright and database rights 2012.
Ordnance Survey 100021668



Notes

LEGEND

- EXISTING ROAD MARKINGS
- PROPOSED WHITE ROAD MARKINGS
- EXTENTS (TLRN, WCC)

NOTES

- Advisory cycle lanes proposed at 1.5m minimum width.
- Drawings have been produced on OS map data, therefore dimensions are subject to on site review.
- Vehicle lane widths vary across the sections of carriageway.

Rev	Description	By	Date	Chk
01	RSA 1 RESPONSE	TS	MAY 23	PW



DEPARTMENT OF TRANSPORTATION AND HIGHWAYS
 Traffic & Transportation Policy Service
 The Royal Borough of Kensington and Chelsea
 Town Hall, Hornton Street, London, W8 7NX
 Telephone: (020) 7361 3374
 Fax: (020) 7361 2796

Project
PROPOSED KENSINGTON HIGH STREET LIGHT SEGREGATION

Title
FOR INFORMATION (EAST OF KEN CH ST)

Scale 1:200	Drawn Date MAR 2023	TS	Checked Date MAR 2023	PW	A1
Drawing Number 001-1200-06	Rev 01				

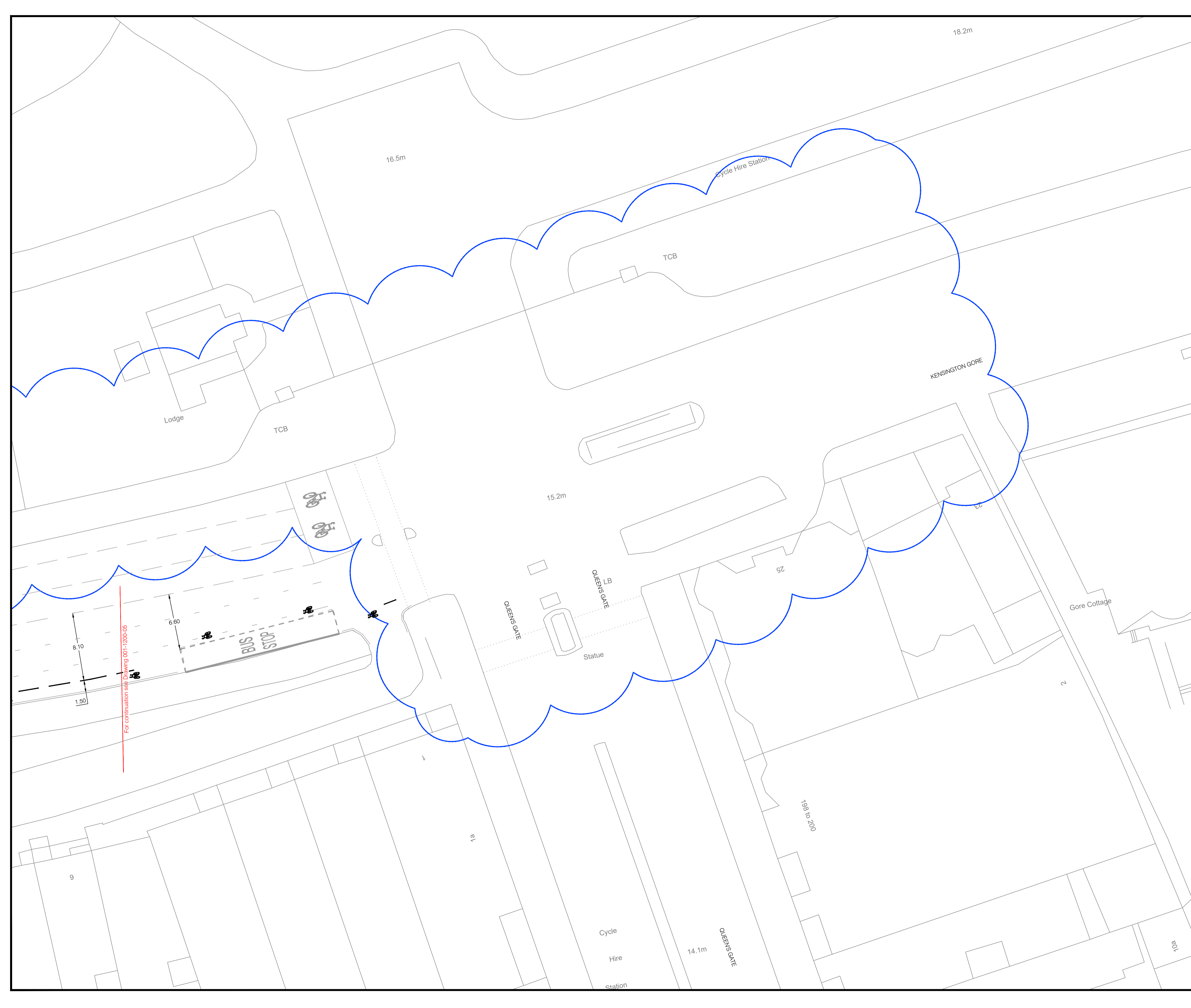
Cad File : \DRAWINGS\...



For continuation see Drawing 001-1200-05