





Legend

-  Proposed full width sinusoidal road hump with 300mm (min) drainage channel to kerb (3.7m length, 75mm high)
-  Proposed road hump signage (hump distances indicative)
-  Sign plate mounted on existing lamp column
-  Sign plate mounted on new post

Client



Notes

- Road hump locations approximate. To be confirmed during detailed design stage.
- Sign plate locations approximate. To be confirmed during detailed design stage.

Rev	Date	Description	DRN	CHK	APP
0	Feb-24	Original Issue	AVE	AVE	ID

Project

NCIL3 AB17 Lexham Gardens
Traffic Calming

Scale	Plot Size	DES	CHK	APP
NTS	A4	AVE	AVE	ID
DATE	Feb-24	Feb-24	Feb-23	

Drawing Title

Lexham Gardens (West Arm)
Preliminary Design
General Arrangement

Drawing No.	Rev
LEXHAM_GDNS-TC-PRELIM-01	0

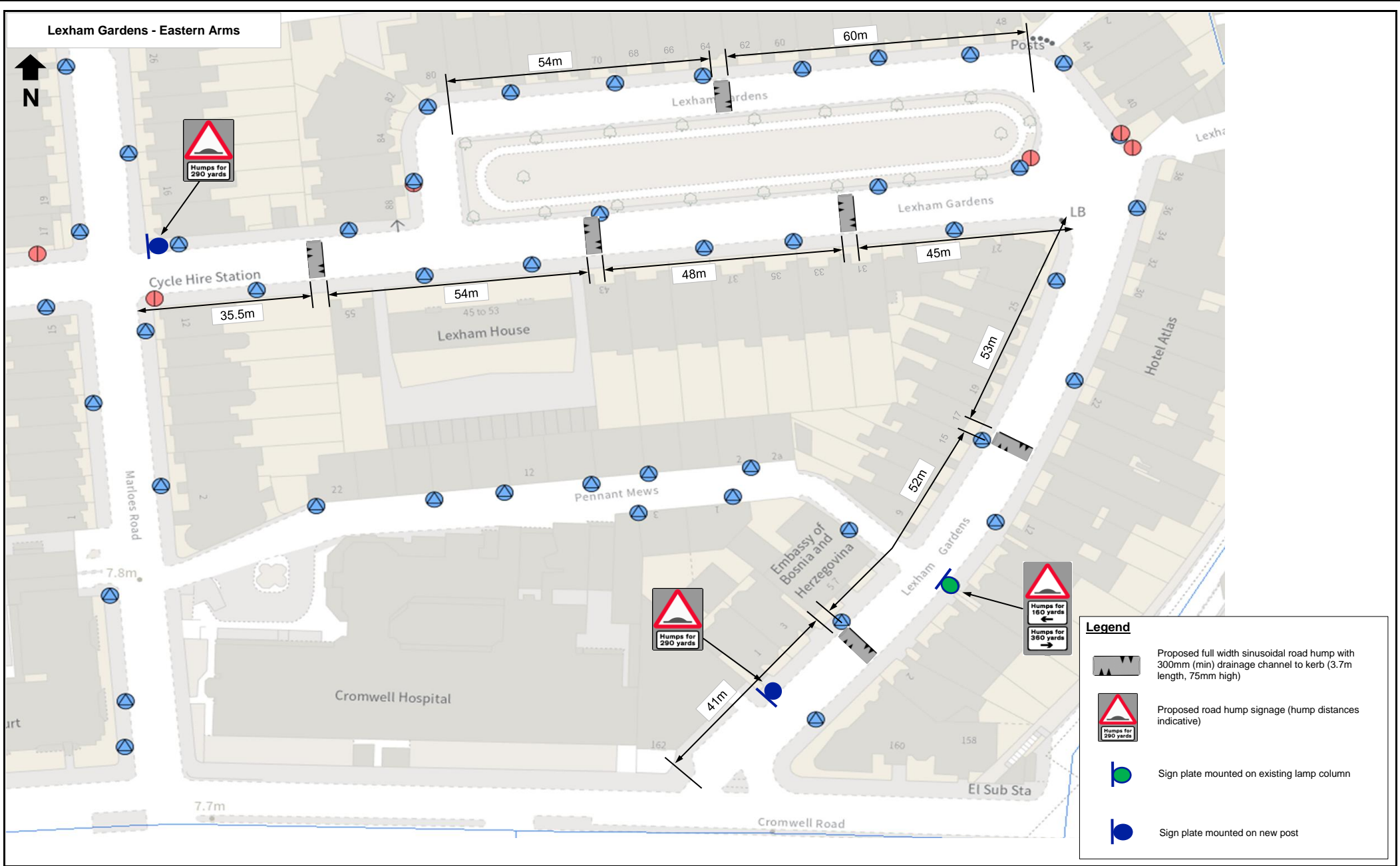

Legend

- Proposed full width sinusoidal road hump with 300mm (min) drainage channel to kerb (3.7m length, 75mm high)
- Proposed road hump signage (hump distances indicative)
- Sign plate mounted on existing lamp column
- Sign plate mounted on new post

Client

THE ROYAL BOROUGH OF
**KENSINGTON
AND CHELSEA**

Notes

- Road hump locations approximate. To be confirmed during detailed design stage.
- Sign plate locations approximate. To be confirmed during detailed design stage.

Rev	Date	Description	DRN	CHK	APP
0	Feb-24	Original Issue	AVE	AVE	ID

Project

NCIL3 AB17 Lexham Gardens
Traffic Calming

Scale	Plot Size	DES	CHK	APP
NTS	A4	AVE	AVE	ID
DATE		Feb-24	Feb-24	Feb-24

Drawing Title

Lexham Gardens (East Arm)
Preliminary Design
General Arrangement

Drawing No.	Rev
LEXHAM_GDNS-TC-PRELIM-02	0