





**Legend**

-  Proposed full width sinusoidal road hump with 300mm (min) drainage channel to kerb (3.7m length, 75mm high)
-  Proposed road hump signage (hump distances indicative)
-  Sign plate mounted on existing lamp column
-  Sign plate mounted on new post

**Client**



**Notes**

- Road hump locations approximate. To be confirmed during detailed design stage.
- Sign plate locations approximate. To be confirmed during detailed design stage.

Rev	Date	Description	DRN	CHK	APP
0	Feb-24	Original Issue	AVE	AVE	ID

**Project**

NCIL3 AB17 Lexham Gardens  
Traffic Calming

Scale	Plot Size	DES	CHK	APP
NTS	A4	AVE	AVE	ID
<b>DATE</b>		Feb-24	Feb-24	Feb-23

**Drawing Title**

Lexham Gardens (West Arm)  
Preliminary Design  
General Arrangement

Drawing No.	Rev
LEXHAM_GDNS-TC-PRELIM-01	0

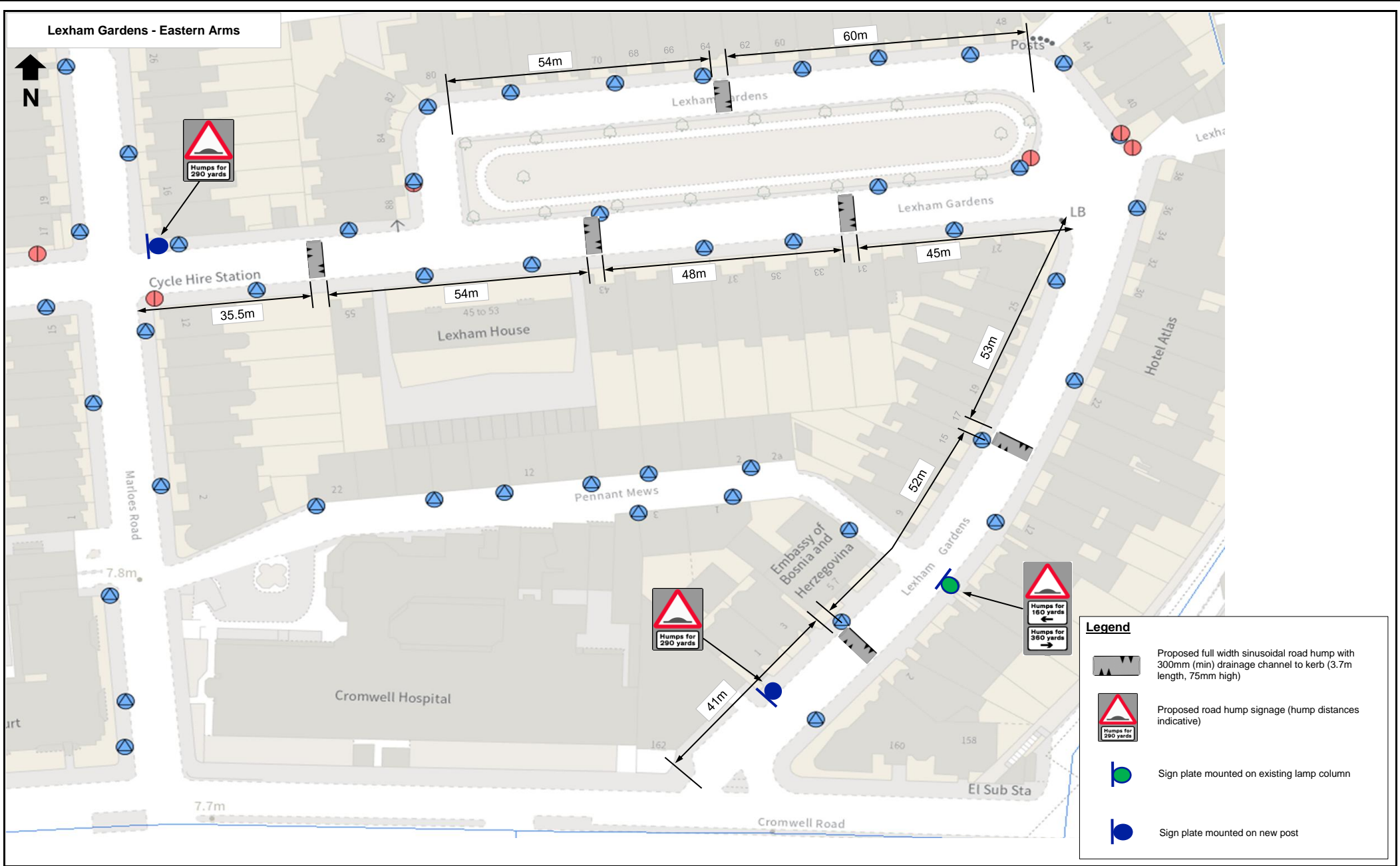

**Client**

THE ROYAL BOROUGH OF  
**KENSINGTON  
AND CHELSEA**

**Notes**

- Road hump locations approximate. To be confirmed during detailed design stage.
- Sign plate locations approximate. To be confirmed during detailed design stage.

Rev	Date	Description	DRN	CHK	APP
0	Feb-24	Original Issue	AVE	AVE	ID

**Project**

NCIL3 AB17 Lexham Gardens  
Traffic Calming

Scale	Plot Size	DES	CHK	APP
NTS	A4	AVE	AVE	ID
<b>DATE</b>		Feb-24	Feb-24	Feb-24

**Drawing Title**

Lexham Gardens (East Arm)  
Preliminary Design  
General Arrangement

Drawing No.	Rev
LEXHAM_GDNS-TC-PRELIM-02	0